

# GENUINE

# INSTRUCTIONS

Thank you for purchasing MAZDA genuine parts.

Please follow the instructions shown below for proper installation.

Instructions must be kept for checkout.

## NOTE

- Observe strictly caution and warning marked  for safe installment and handling.
- Do not modify parts.
- Avoid installation and / or handling unspecified in this instructions.
- Install at a MAZDA dealer to prevent improper installation.
- For further information please contact a MAZDA dealer.
- We shall not be responsible for any defects occurred in failure to observe Caution and Warning specified.

1

Part No: NC10 V3 450F

Part name: MUD FLAP (FRONT)

Application model: ROAD STAR

※If you have any questions, please contact a Mazda dealer.

## NOTE

Return these instructions to the customers after installation

2

**FINISHED SKETCH**

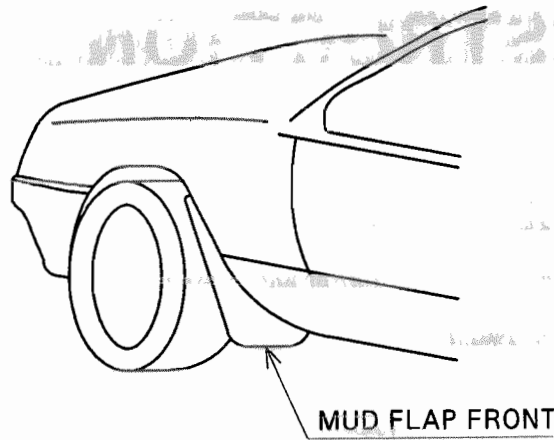

3

**COMPONENTS PARTS (Before installing, check components with list.)**

**⚠ CAUTION**

Be sure of a complete set of components and no dirt, no scratches and no damages.

No.	COMPONENTS NAME	QTY	No.	COMPONENTS NAME	QTY
	FLAP RIGHT / LEFT	1 ea	⑦	RIVET	2 ea
②	GROMMET (WITH STOPPER)	2 ea	⑧	GROMMET (LARGE)	2 ea
③	TAPPING SCREW (M5 L20)	2 ea	⑨	GROMMET (SMALL)	2 ea
④	TAPPING SCREW (M5 L16)	2 ea	⑩	BRACKET	2 ea
	TAPPING SCREW (M4 L12)	2 ea	⑪	INSTRUCTIONS	1
⑥	CLIP	2 ea			

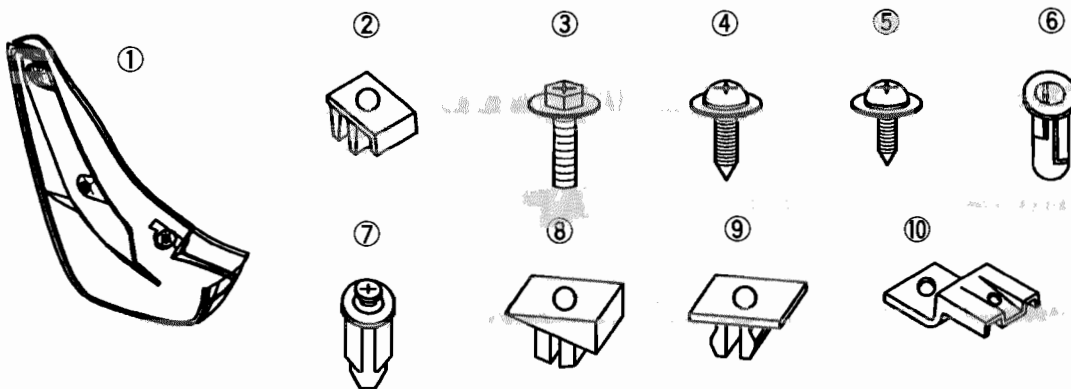

4

**TOOLS (Prepare tools for installation.)**

PHILLIPS  
SCREWDRIVER

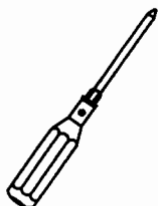

WHITE  
GASOLINE

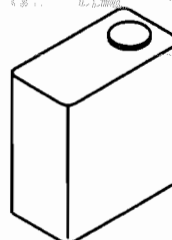

# 5

## REMOVAL FROM VEHICLE

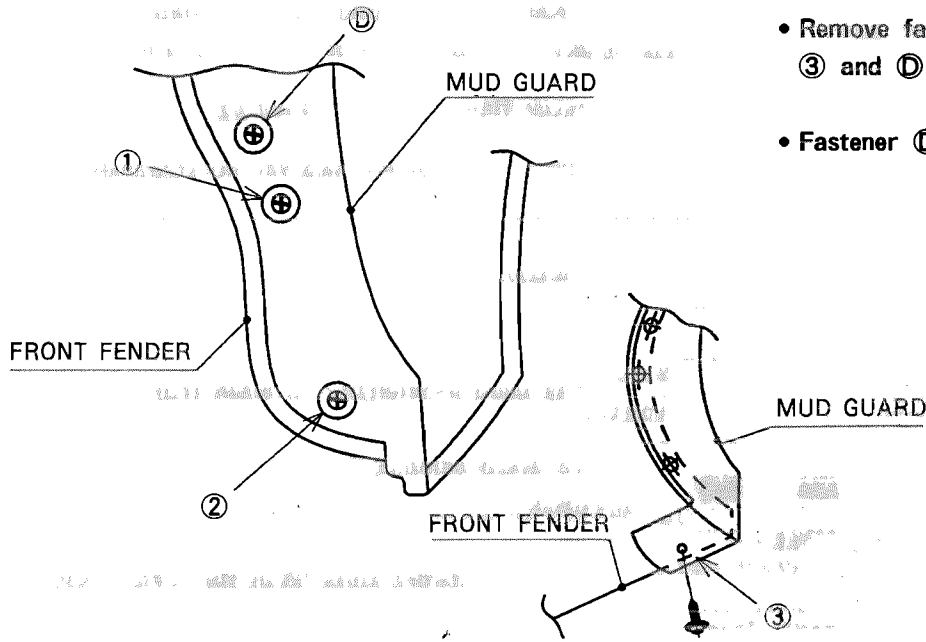

- Remove fasteners from ①, ②, ③ and ④
- Fastener ④ is to reassemble

# 6

## INSTALLATION TO VEHICLE

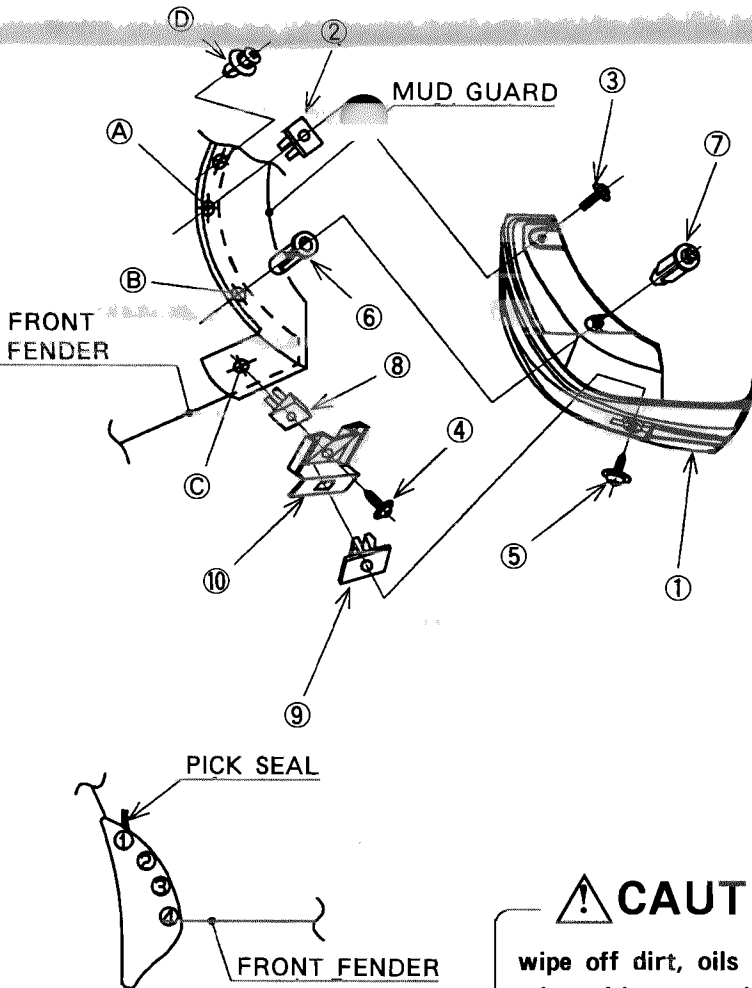

- Turn over MUDGUARD and install ② to ④
- Turn over MUDGUARD and install ⑥ to ⑧
- Assemble fastener ④ removed in step 5
- Install ⑧ to ③ on MUDGUARD, ⑨ to ⑩ and tighten ④
- Set flap without clearance between flap and front fender and tighten screw ③ in ④
- Install flap to ⑥ with ⑦ and tighten ⑤ screw in ⑨ without clearance
- Pull pick seal to peel double side tape from liner table and apply it in numerical order ① to ④ without clearance between flap and fender

How to apply double-side tape

### CAUTION

wipe off dirt, oils and fats from fender with waste cloth containing white gasoline

**7****CONFIRMATION AFTER INSTALLING**

- Check that clearance between flap and fender is within a range of 0 to 0.5mm.
- check flap for no loose-fitting.
- Check flap painter face for no scratches.

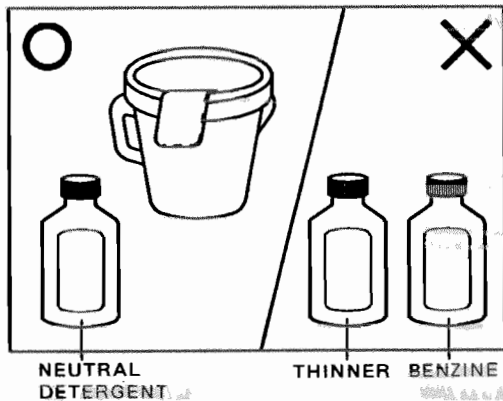
**8****HANDLING**

- Use neutral detergent to wash flap.
- To avoid damage, do not use thinner and benzine.
- To avoid deformation, keep flap away from fire.

✘Contact dealer for any questions.